



## **ASSEMBLY INSTRUCTIONS**

Mobile welding protection screen

SSW3550



Please read this manual before using the product and follow the instructions it contains!

## GENERAL

Foreword	3
Safety instructions	3
Technical data	3
Parts list	4
Assembly	5

## MAINTENANCE

Warranty	6
Service & contact	6

## FOREWORD

Congratulations on the purchase of your new SSW3550 mobile welding shield. The SSW3550 has been manufactured from high quality materials, specifically designed for durable and reliable use. For your own safety and correct operation, be sure to read and follow these assembly instructions before operating the unit.

Keep these assembly instructions. Check the welding protection panel for transport damage. Damaged individual parts must not be put into use. The SSW350 serves to protect uninvolved persons from dangerous radiation, spatter and welding arcs during welding. Improper handling may result in injury or damage.

Any liability for damage resulting from improper use of the SSW3550 mobile welding protection panel or failure to observe the specifications and rules of conduct in these installation instructions is excluded. The operator is responsible for ensuring correct use by trained and authorized personnel.

## SAFETY INSTRUCTIONS

- Always wear safety-relevant protective clothing during welding, which protects your eyes and body from heat and flying sparks.
- Rising toxic vapors and gases should always be extracted via a suitable extraction device.
- Welding workstations must be shielded so that uninvolved persons are protected from radiation, noise and welding spatter.
- Shielding against optical radiation or sound must not extend completely to the floor. The air inlet during welding must be as draft-free as possible in the lower area of the room.
- The welding curtain should not serve as the sole protection against emissions. These are necessary when welding arcs are observed from a distance of less than two meters.

## TECHNICAL DATA

### FRAME

Type	Unit	Value
Model		SSW3550
Width	mm	1950
Depth	mm	800
Height	mm	1950
Weight incl. curtain	kg	23.5
Material		Steel
Surface		Powder-coated
Castors	Pieces	4
Castor type		Swivel castors; 2 lockable
Colour		Blue

### SAFETY CURTAIN

Type	Unit	Value
Length	mm	3750
Width	mm	1740
Material		PVC
Material thickness	mm	0.4
Colour		Red

## PARTS LIST

No.	Element	Quantity
1	Swivel castors (lockable + rollable)	2 x 2
2	Round connecting rods	2
3	Swivel arms	2
4	Square bars long	2
5	Square bars short	2
6	Rings (+replacement)	16 (+1)
7	End caps	6
8	Screws long + washers	4 + 4
9	Screws short + nuts	4 + 4
10	Curtain	2

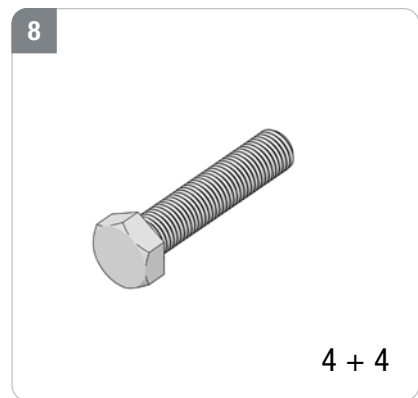
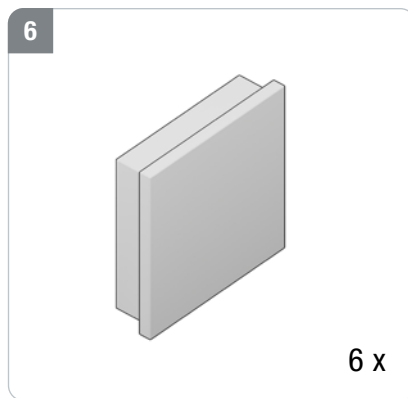
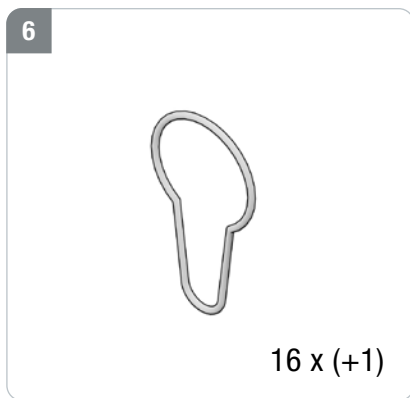
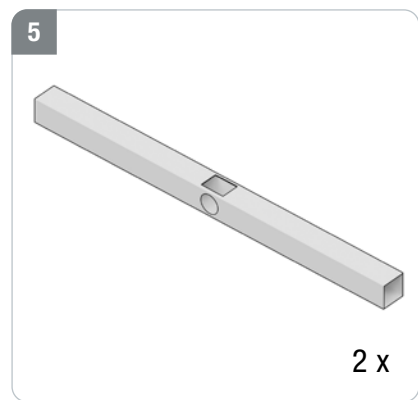
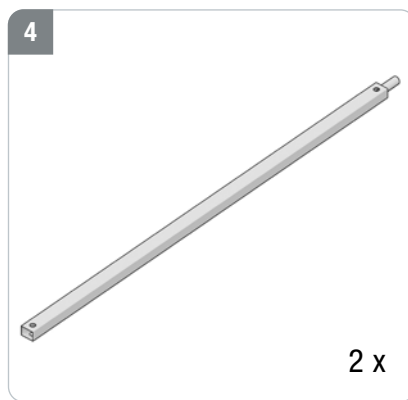
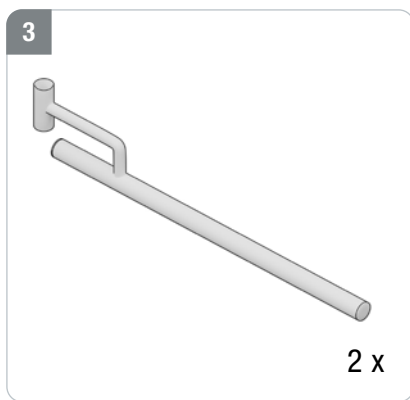
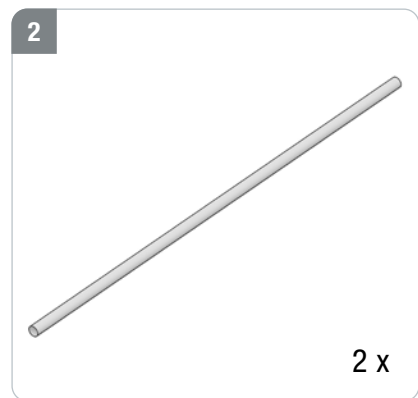
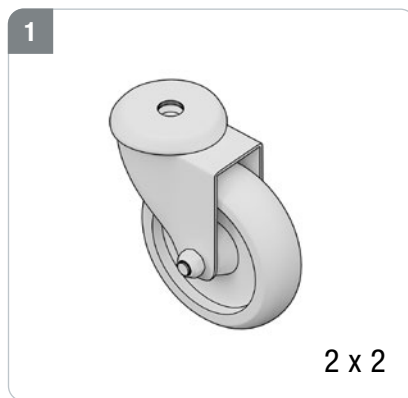
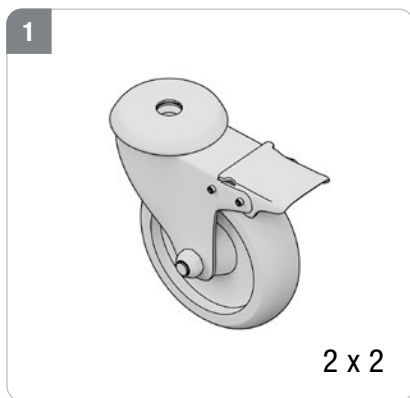

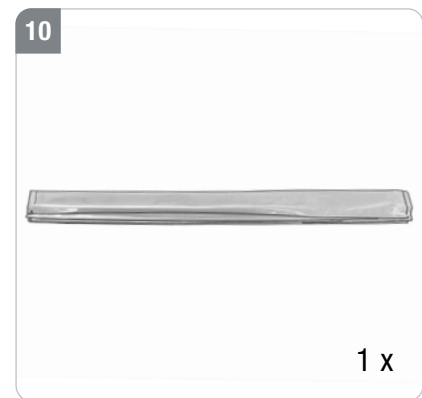
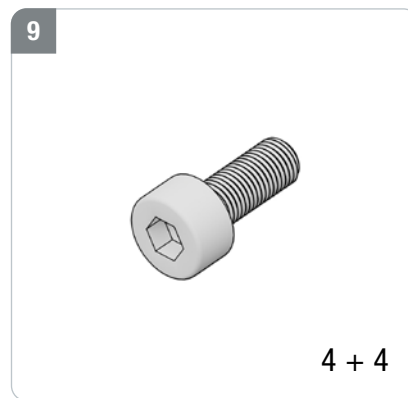
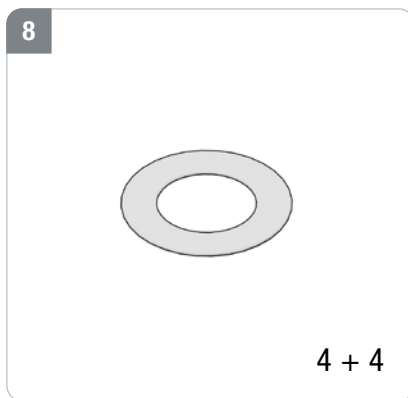

## ASSEMBLY

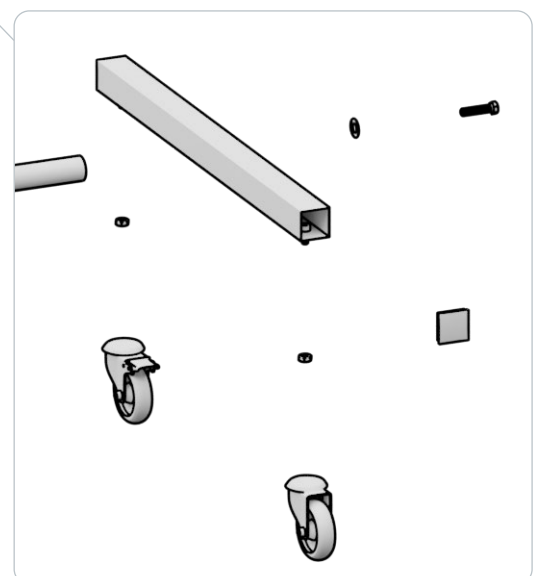
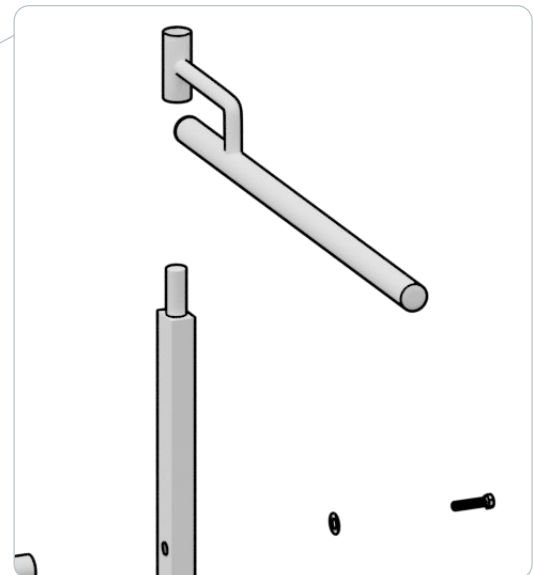
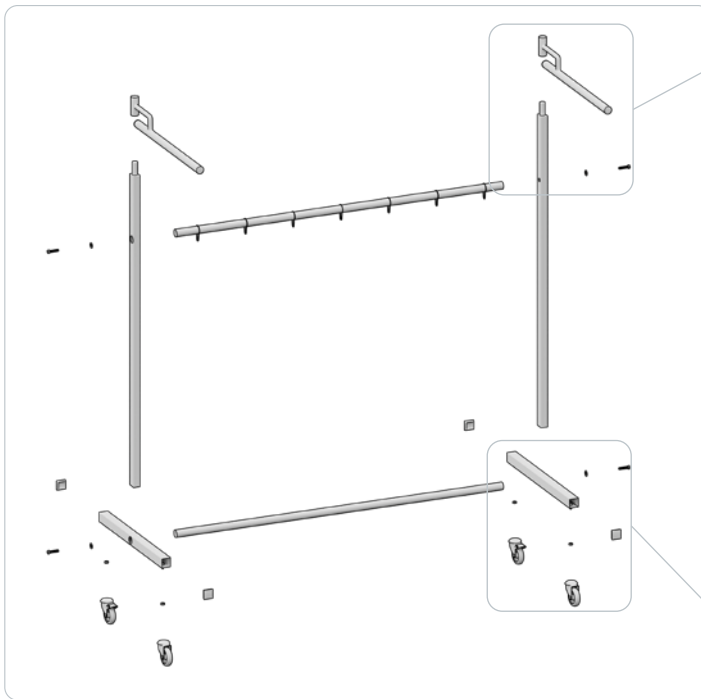

1. Screw the four rollers (1) onto the square short rods (5).
2. Insert the two square long rods (4) into the square holes provided in the short square rods (5). Now insert the lower round connecting rod (2) tube into the round holes of the short square rods (5) and screw everything together tightly.
3. Insert the eight rings (6) through the upper round connecting rod (2).
4. Now insert the upper connecting rod (2) into the round holes of the vertical square long rods (4) and screw both sides together.
5. Attach the two swivel arms (3) on both sides.
6. Put the four rings (6) through both arms.
7. Hang the curtain (10) in all 16 rings (6).

## WARRANTY

This mobile safety barrier is certified according to EN ISO 25980 and complies with the basic requirements for health and safety. The product meets the requirements for optical and physical properties, light transmission, UV filtering efficiency, hazard level, light reflectance, UV spectral reflectance, UV stability and flammability as described in the relevant European and / or international standards.

## SERVICE & CONTACT

Contact our product experts and find help and solutions for your product. Here you will find all contact information listed by country and language: [www.topregal.co.uk/en/service](http://www.topregal.co.uk/en/service)

Responsible for the content:

TOPREGAL GmbH

Industriestrasse 3

70794 Filderstadt

GERMANY

[www.topregal.com](http://www.topregal.com)

**TECMASCHIN**