



OPERATING INSTRUCTIONS

Scrubber dryer
SWM33



Please read this manual before using the product and follow the instructions it contains!

GENERAL

Foreword	3
Safety instructions	3
Technical data	3
Overview of the main components	4
Instruction manual	5
Emptying the tanks	6

MAINTENANCE

Service and maintenance	6
Troubleshooting	7
Packaging and disposal	7
Service & Contact	7
UKCA Declaration of Conformity	8

PARTS LIST

Parts list	9
------------	---

FOREWORD

Congratulations on the purchase of your new SWM33 scrubber dryer. This easy to use cleaning machine is made of high-quality materials and was especially designed for a reliable use and to last long. For your own safety and for the correct operation of the machine, please read and follow these instructions before using the machine.

Keep this instructions manual. Check the cleaning machine for transport damage. Damaged scrubber driers must not be used.

The SWM33 is a powerful scrubber-dryer for the residue-free cleaning of smooth floors and is therefore ideal for hotels, guesthouses, office buildings, stores and exhibition halls. Improper handling can cause damage to the machine or injuries.

The operator / user must ensure correct use, making sure that the scrubber drier is only used by instructed and authorized persons.

SAFETY INSTRUCTIONS

- Read and follow the instructions in this manual and the warning labels on the device before using it.
- Only operate the machine if you are familiar with it.
- Use the SWM33 only after you have checked its proper condition.
- Use the machine indoors only. Do not expose the machine to precipitation.
- Do not use the machine in explosive environments.
- Never sit or stand on the scrubber drier.
- This scrubber-dryer is only suitable for 220 V AC, 50 Hz.
- Only use the original accessories supplied with the machine.
- Never place the SWM33 directly next to a heater or oven.
- Do not use abrasive cleaners (scouring agents, thinner) to clean the scrubber dryer. These could attack the plastic surface.
- This device is not suitable for use by physically, sensorially or mentally impaired people.
- If the power cord is damaged or loose, it must be replaced by the manufacturer's service department or by qualified personnel.
- Be sure to unplug the power cord from the wall outlet before cleaning the machine.
- Always disconnect the appliance from the power supply after using it.
- Do not place the device in rooms where temperatures may fall below freezing point, as this will damage the nozzles and lines.
- Modifications and changes to the device not approved by the manufacturer will void the warranty.

TECHNICAL DATA

GENERAL

Type	Unit	Value
Model		SWM33
Size	mm	1040 x 770 x 1160
Width of the wiper bar	mm	770
Diameter brush	mm	440
Turning radius	mm	180
Cable length	m	18
Rated voltage	V	220
Total weight	kg	88
Fresh water tank	l	33
Wastewater tank	l	31
Tires		Solid rubber
Detergent		Neutral / alkaline all-purpose-automatic cleaner

PERFORMANCE

Type	Unit	Value
Cleaning area	m ² /h	1600
Rotation speed brush	rpm	170
Brush pressure	kg	25
Brush motor power	W	550
Suction engine power	W	400
Sound pressure level	dB (A)	75

OVERVIEW OF THE MAIN COMPONENTS

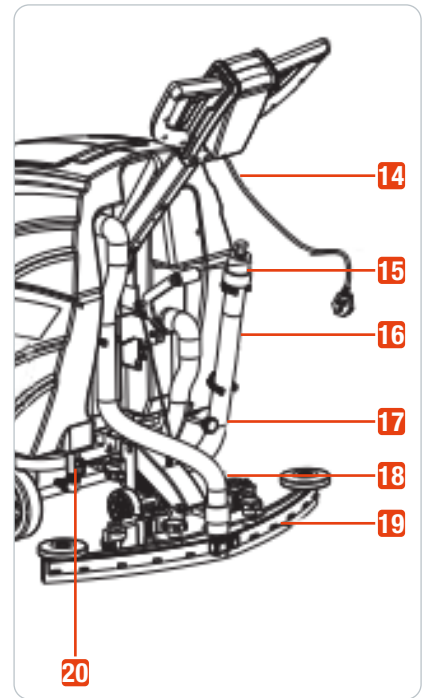
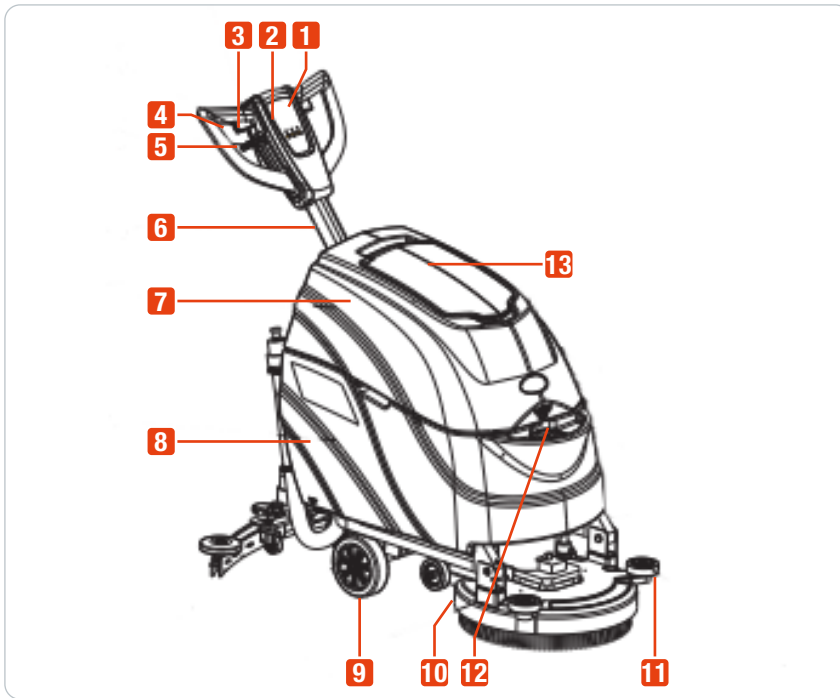

No.	Name
1	Left switch handle
2	Control panel
3	Right switch handle
4	Safety switch
5	Drawbar adjustment lever
6	Drawbar
7	Waste water tank
8	Fresh water tank
9	Rear wheel
10	Brush disc

No.	Name
11	Anticollision wheel
12	Fresh water tank cover
13	Waste water tank cover
14	Power cable 18 m
15	Lowering lever for suction strip
16	Waste water hose
17	Brush lock rod
18	Suction hose
19	Wiper bar
20	Rotary knob for water amount

ACCESSORIES



Brush



Brush attachment



Wiper bar

INSTRUCTION MANUAL

NOTES

- Persons who do not operate the machine must keep sufficient distance to the machine to prevent injuries.
- The SWM33 stops operation as soon as the waste water tank is full.
- To guarantee a long lifetime the scrubber drier must be cleaned regularly.
- Use in rain is prohibited.
- Both hands must be on the handles before starting the machine.

FIRST STEPS

After opening the packaging, adjust the drawbar, connect the hoses of the water tank and the cables. Install the squeegee.

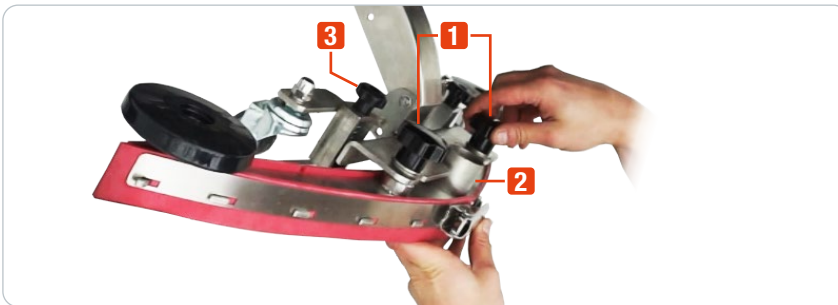

ATTACH THE WIPER BAR

1. Make sure that the lever for lowering the wiper bar is up.
2. Loosen the two fixing screws (1) and attach the wiper bar.
3. Tighten the fixing screws.
4. Connect the suction hose to the opening of the suction head (2).
5. You can also change the height of the wheels (3).

USAGE

- A** On / off switch
- B** Suction motor switch
- C** Switch for fresh water supply
- D** Display brush (on / off)

1. Add the appropriate water solutions to the fresh-water tank depending on your cleaning requirements.
2. Make sure that the brush is lowered before starting.
3. Plug the power plug into a correctly installed grounded contact socket.
4. Lower the wiper bar (15).
5. Press the "On / Off" button so that it lights up, then unlock the red safety switch (4) on the right side of the handle and hold down the right (3) and left switches (1).
6. The machine starts and the brush rotates. The light (D) is on.
7. At the front side of the handle are the following switches: suction motor and fresh water supply. When the lights above the buttons are on, they are active.
8. The quantity of the water supply can be adjusted with the knob (20).
9. If you want to push the machine without using the cleaning functions, we recommend to keep the brush in a lifted position and to lock it with the brush locking bar.

PARKING AND STORAGE

1. After use, switch off the machine by pressing the on / off switch.
2. The light on the on / off switch turns off.
3. Unplug the power plug.
4. Wind up the power cable.
5. Clean the rubber lips on the suction head with a cloth.
6. Empty and clean the tanks and hoses.
7. Store the machine so that it is protected and does not become a tripping hazard.

EMPTYING THE TANKS

Note: Before emptying the waste and fresh-water tank, the SWM33 must be disconnected from the electrical circuit. Empty the fresh and waste-water tank after each use and clean the water pipes to avoid blockages. After finishing work, all parts must be dried.

EMPTYING THE WASTE WATER TANK

1. You can either remove the waste-water tank, or transport the entire machine to a manhole cover or another drain for waste water.
2. Remember to disconnect the two hoses and the cable if you remove the waste water tank.
3. Hold the waste water hose over the drain and open it.
4. Drain all waste water completely.
5. Remove coarse dirt and deposits manually. Wear gloves.
6. Rinse the protective water tank with fresh water and remove deposits from the tank walls with a clean cloth.

EMPTYING THE FRESH WATER TANK

1. Transport the machine to a manhole cover or drain.
2. Open the fresh water drain valve.
3. Drain the water completely.

SERVICE AND MAINTENANCE

1. Despite the moisture-proof construction, it must be ensured that no water enters the machine's electrical circuit.
2. In case of a defect at the machine, it must not be repaired independently. Please contact our customer service.

REPLACEMENT OF THE BRUSH

1. Wear working gloves when changing the brush.
2. Bring the brush into position.
3. Lift out the brush with a jerky clockwise rotation.
4. Remove the brush.



Fixed brush

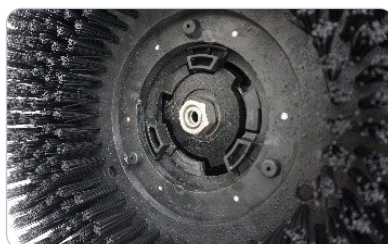

Loosened brush



For cleaning delicate floors, we recommend the use of a cleaning pad. This is used with the brush attachment.

TROUBLESHOOTING

Problem	Cause	Solution
Slow motor start-up	Poor contact between motor and carbon brush	Check, clean or replace the carbon brush
The motor does not rotate	The power switch is damaged, the power supply is not connected or is not supplied with power	Check power switch for damage and replace if necessary. Ensure the power supply
The brushes rotate slowly	Heavily worn carbon brushes lead to bad contact	Replace carbon brush
Suction motor works but does not suck in water	Clogged hoses, leaking wiper bar connections	Check for clogged hoses and leaking squeegee connections
Motor rotates but brush does not move	The meshing parts between rotor and gear are worn	Replace the motor rotor or gearbox
Drawbar cannot be adjusted	Drawbar is loose or the tines of the drawbar are rusty	Tighten the screws on the drawbar or replace them if necessary

PACKAGING AND DISPOSAL

PACKAGING

The packaging and individual components are made of recyclable materials. In detail these are: Films and bags made of PE (polyethylene), cardboard packaging.

DISPOSAL OF THE OLD DEVICE

(Applicable in the European Union and other European countries with systems for separate collection of recyclable materials)

Old devices must not be disposed of in the household waste!

If the device can no longer be used, every consumer is legally obliged to dispose of old devices separately from household waste, e.g. at a collection point in his community.



SERVICE & CONTACT

Contact our product experts and find help and solutions for your product. Here you will find all contact information listed by country and language: www.topregal.co.uk/en/service

Responsible for the content:
 TOPREGAL GmbH
 Industriestrasse 3
 70794 Filderstadt
 GERMANY
www.topregal.com

UKCA Declaration of Conformity

The manufacturer

**TOPREGAL UK Ltd.
Carlton Drive Crumlin
Gwent NP11 4EA**

hereby declares that the following product

Product name:

wipeket Scrubber dryer

Type:

SWM33

Serial number:

SWM33-1000000000-SWM33-9999999999

that the equipment is in conformity with the following relevant UK legislations and applied standards:

2006/42/EC Machinery Directive

EN 60335-1+A11+A13

EN 60335-2-67

EN 60335-2-69

EN 62233

Name and address of the person who is authorized, compile the technical documentation:

TOPREGAL UK Ltd.
Carlton Drive Crumlin
Gwent NP11 4EA



Place: Crumlin UK
Date: 31.03.2021

Juergen Effner
Chief Executive Officer

PARTS LIST

No.	Name
1	Wastewater tank cover
2	Float
3	Wastewater tank
4	Level switch cover
5	Water level limit switch
6	Fan sponge
7	Filter support
8	6 x 50 hexagonal screws
9	Suction engine
10	Wave
11	TM14 x 15 screws
12	Circuit cover
13	Circuit
14	Pipe fixing clamp
15	Silencer pipe
16	Fresh water tank cover
17	Fresh water tank
18	Main frame
19	Brush motor
20	Hexagon head screw 6 x 50
21	Outer plastic triple plug
22	Brush plate
23	Brush
24	Outer plastic triple plug
25	10 x 100 hexagon head screws
26	Wheels
27	8 x 25 hexagon head screws
28	Washer
29	Squeegee on frame
30	Suction Head
31	Wastewater hose
32	Suction hose
33	Drawbar

